

Site Plan Scale 1:1250

Children and young persons are permitted access to all public parts of the premises

Square Meters						
Store Name		Helnsbrugh				
Store Number		1664				
Number Of Units	Bay/Fixture	Height	Width	Depth	M2	
0	Side Rack	1720	610	300	0.00000	
<b>Total Display Units Capacity</b>					<b>0.00000</b>	
2	1000 Fixture	1410	1000	470	2.82000	
0.00	800 Fixture	2060	1206	470	0.00000	
2.00	Kiosk Kit	1800	1000	300	3.60000	
3.00	1250 Panama fridge bay	1800	1250	750	6.75000	
0.00	937 Panama fridge bay	1800	937	750	0.00000	
0.00	1250 Pearl M fridge bay	1800	1250	750	0.00000	
0.00	937 Pearl M fridge bay	1800	937	750	0.00000	
<b>Total Shelving Capacity</b>					<b>13.17000</b>	
<b>Miscellaneous BWS Display Base</b>						
Visible Display	Display Base	2200	610	610	0.00000	
<b>Total Department Capacity</b>					<b>13.17000</b>	

Key - Drawing Information

[Red Hatched]	FIXTURE LICENCED FOR SALE OF ALCOHOL - ACCESSIBLE
[Green Hatched]	FIXTURE LICENCED FOR SALE OF ALCOHOL - INACCESSIBLE
[Blue Line]	BOUNDARY OF PREMISES SALES FLOOR
[Yellow Line]	LOCATION OF PREMISES ON SITE PLAN

Key - Fire Symbols

[Symbol]	NOTICE - 'FIRE DOOR-KEEP CLOSED'
[Symbol]	NOTICE - 'KEEP LOCKED'
[Symbol]	ILLUMINATED EXIT DIRECTION
[Symbol]	EXIT SIGN
[Symbol]	EMERGENCY LIGHTING
[Symbol]	FIRE ALARM CALL POINT
[Symbol]	AUDIBLE WARNING
[Symbol]	SMOKE DETECTOR
[Symbol]	SMOKE DETECTOR
[Symbol]	ALARM INDICATOR PANEL
[Symbol]	DOORS FITTED WITH PUSH BARS
[Symbol]	DOORS FITTED WITH PRESSURE RELEASE
[Symbol]	GLASS SHUTTER DOOR
[Symbol]	FIRE EXTINGUISHER - WATER TYPE
[Symbol]	FIRE EXTINGUISHER - FOAM TYPE
[Symbol]	FIRE EXTINGUISHER - CARBON DIOXIDE
[Symbol]	FIRE EXTINGUISHER - DRY POWDER TYPE
[Symbol]	FIRE EXTINGUISHER - AQUEOUS SOLUTION
[Symbol]	FIRE EXTINGUISHER - VAPOURISING LIQUID
[Symbol]	FIRE BLANKET
[Symbol]	FIRE HOSE REEL
[Symbol]	FIRE RESISTANT WALLS
[Symbol]	FIRE RESISTANT DOORS

NOTES:  
1. FIRE FIGHTING EQUIPMENT & ALL OF THE REQUIREMENTS OF THE FIRE SERVICE WILL BE INCORPORATED & WILL BE PROVIDED TO COMPLY WITH THE EUROPEAN STANDARDS

No. BSEN3 & BS7863.  
FIRE STANDARDS:  
1. FIRE SAFETY RELATED SIGNS AND NOTICES ARE TO THE HEALTH AND SAFETY (SAFETY SIGNS & SIGNALS) REGULATIONS ACT 1996. THOSE THAT COMPLY TO BS 5499, PART 1, 1990 ALSO COMPLY.  
2. ILLUMINATED 'EXIT' SIGNS ARE TO CONFORM TO BS2560  
3. FIRE FIGHTING EQUIPMENT IS TO COMPLY WITH EUROPEAN STANDARDS BS EN3 AND BS 7863

NOTE:  
TOTAL ALCOHOL DISPLAY AREA: 13.17000m<sup>2</sup>

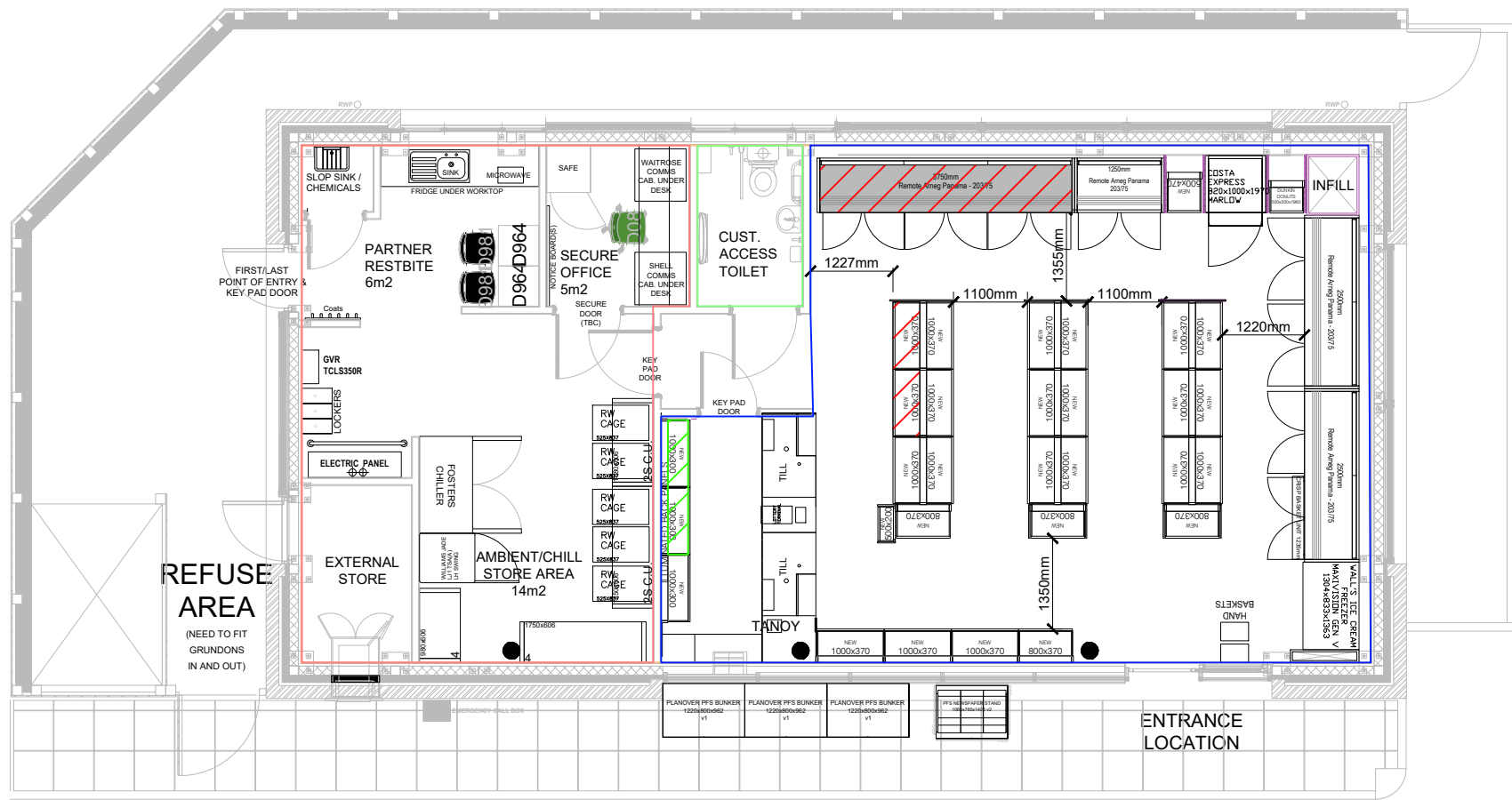

Store Number 001

## 1664 HELENSBURGH

CARDROSS ROAD HELENSBURGH G84 7LA

---

SALES FLOOR

---

RETAIL SALES AREA 812 Sq. Ft.

---

Scale: 1:100 only scaled on **A3**